

* NOTICE *
 INFORMATION CONTAINED HEREIN IS PROPRIETARY TO AEROTWIN, INC. AND MAY NOT BE DISCLOSED IN WHOLE OR IN PART OR USED FOR ANY DESIGN OR MANUFACTURE UNLESS THE USER POSSESSES DIRECT WRITTEN AUTHORIZATION FROM AEROTWIN, INC..

ISS	DESCRIPTION	INIT	DATE
1	INITIAL RELEASE		

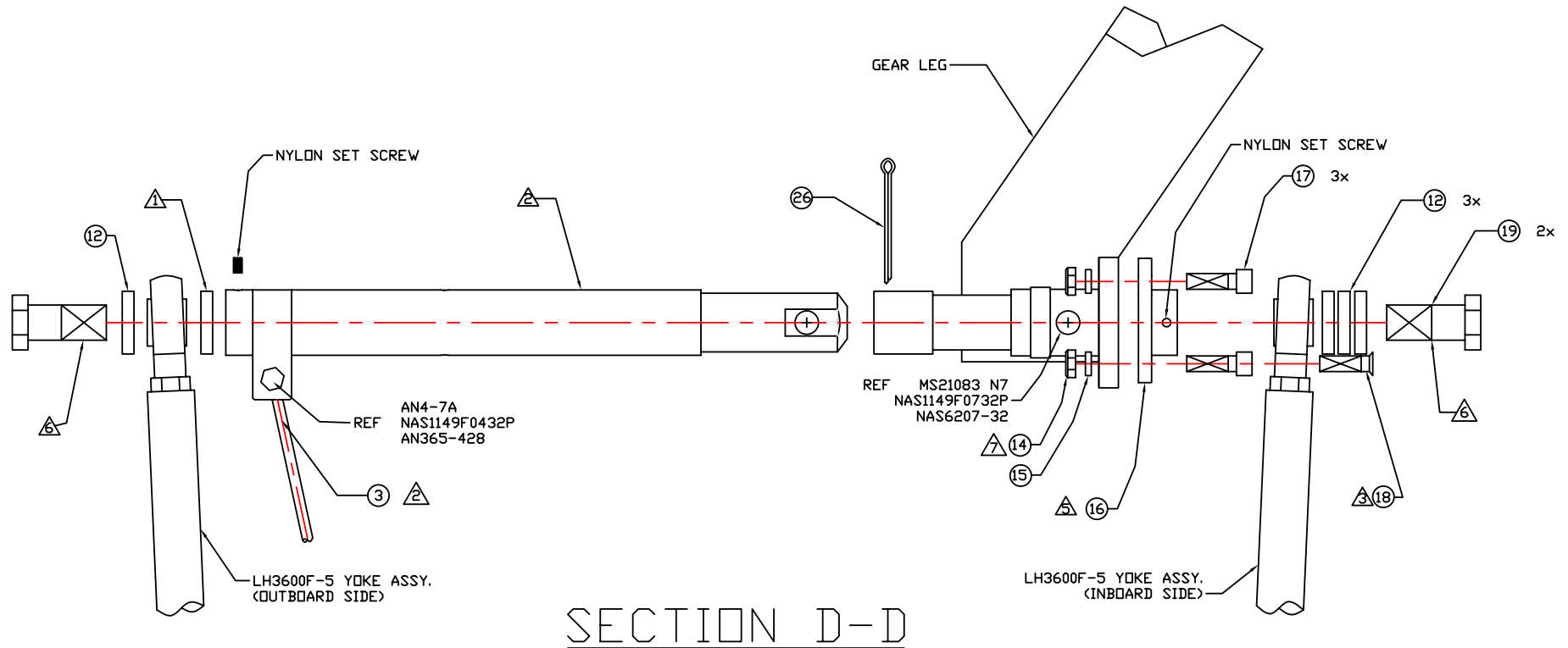

SECTION D-D

ENGINEERING NOTES:

- ① USE P/N NAS1149F1290P, ITEM-12, IF NECESSARY FOR BEST FIT.
- ② SAFETY STOP CABLE ASSEMBLY INCLUDES ALL NECESSARY INSTALLATION HARDWARE.
- 3. COUNTSUNK SCREW, ITEM-18, IS SCREWED THROUGH THE FORWARD, BOTTOM, COUNTERSUNK HOLE IN THE FLANGE.
- 4. SEE BILL OF MATERIALS ON SHT 6.
- ⑤ FOR LEFT SIDE USE ITEM-16 AND FOR RIGHT SIDE USE ITEM-20.
- ⑥ TORQUE TO 65-75 FT. LB.
- ⑦ TORQUE TO 120-145 IN. LB.

DRAWN B. SLATER	DATE 01/04/2008	TOLERANCES UNLESS STATED OTHERWISE: .X ± 0.050 .XX ± 0.030 .XXX ± 0.010 ANGLES ± 1.5' ALL DIMENSIONS ARE IN INCHES MACHINED SURFACES: FINISH TO 125 OR BETTER	<i>AeroTwin, Inc.</i>	
CHECKED			TITLE AIRGLAS LH4000F RIGGING INSTALL	
DESIGN			SHEET 5 OF 6	ISSUE 1
MANUFACTURE			DRAWING NO. FND-SKI-1020	
ENGINEERING DEPT. APPROVAL			MOD. NUMBER	PLOT SCALE NTS
APPROVAL			NEXT ASSEMBLY	
EFFECTIVITY PART NUMBER	EFFECTIVITY GENERAL		DO NOT SCALE PRINT	