

SERVICE NOTES

- 1 CHECK WHEEL ALIGNMENT PER CESSNA INSTRUCTIONS FOR BEST SKI OPERATION, FAVOR LOWER LIMIT FOR TOE IN AND CAMBER.
- 2 REMOVE BUNGEE BEFORE CHANGING SKI POSITION.
- 3 AIRCRAFT WEIGHT MUST BE ON TIRE TO CHANGE POSITIONS.
- 4 WHEEL BEARINGS SHOULD BE PACKED WITH LOW TEMP GREASE.

INSTALLATION NOTES

- 1 TIGHTEN NAS1312-15 BOLT UNTILL IT JUST MAKES CONTACT WITH OILITE BEARING THEN TIGHTEN 1/8 TURN. (WARNING DO NOT TIGHTEN BEYOND, OR OILITE BEARING WILL BE CRUSHED.)
- 2 INSTALL NYLON LOCK SCREW NS-10-32-3 UNTILL VISIBLE IN BORE. NAS1312-15 BOLT WILL BE SAFELY HELD WHEN THREADED OVER LOCK SCREW.
- 3 AXLE END PLAY IS CONTROLLED BY PLACING THE PROPER NUMBER OF WASHERS BETWEEN THE INBD. FITTING AND FLANGE, AND BETWEEN OUTBD FITTING AND STUB AXLE.
- 4 MAINTAIN BRAKE CASTING TO WHEEL WELL CLEARANCE WHEN SKI IS IN FLIGHT ATTITUDE.

NOTES

- 1 USE ONLY APPROVED 8020 LOW TEMP SHOCK RINGS THEY ARE IDENTIFIED BY AN ORANGE STRIPE WOVEN OPPOSITE FROM THE YEAR IDENTIFICATION BANDS. INSPECT SHOCK RINGS FREQUENTLY AS THEY MAY BE DAMAGED WHEN EXPOSED TO EXCESSIVE HEAT OR PETROLIUM PRODUCTS. WHEN NOT IN USE: STORE IN COOL, DARK, DRY PLACE.
- 2 STUB AXLE PART NUMBER LW3600-180A-5 MAY ONLY BE INSTALLED IN CESSNA AXLE P/N 1441003-1.
- 3 THE FOLLOWING BRAKE ASSEMBLIES ARE ELIGIBLE FOR THIS SKI INSTALLATION
 GOODYEAR P/N GY95321B1
 CLEVELAND P/N 30-52, 30-52D, 30-52N
 MCCAULEY (CESSNA P/N C163032-0205, 06, 07, 08. MCCAULEY ONLY ELIGIBLE WITH SKI SERIAL NO. 500 AND ON.
 USE BRAKE SPACER P/N LW3600-180-8 WITH CLEVELAND BRAKE DISC P/N 164-7 OR 164-15A FOR INSTALLATION OF 8.50 X 6 GOODYEAR TIRES. DO NOT USE ABOVE BRAKE SPACER WITH DEEP CLEVELAND BRAKE DISC P/N 164-36, AS INSUFFICIENT BRAKE TO SKI CLEARANCE WILL RESULT.

INSTALLATION PROCEDURE

1. JACK UP AIRCRAFT. REMOVE WHEELS, BRAKES, AND AXLES.
2. INSTALL STUB AXLE IN AXLE (31,20) IN ACCORDANCE WITH SHEET 2. (SEE DETAIL C) INSTALL AXLE, BRAKE ASSY, AND FLANGE (19) WITH NAS BOLTS (30, 27) PROVIDED. USE NUTS (13, 10) PROVIDED, AND WASHERS (14, 11) PROVIDED.
3. REMOVE EXISTING TIRE AND TUBE FROM WHEEL.
4. INSTALL 8.50 X 6 TIRE AND TUBE (NOT FURNISHED). NOTE- IF CLEVELAND WHEEL, BOLTS (28) (NOT FURNISHED) WILL BE NEEDED IF SPACER (28) IS NEEDED FOR TIRE TO BRAKE CLEARANCE (MINIMUM 1/16).
5. INSTALL WHEEL PER CESSNA INSTRUCTIONS.
6. PLACE SKIS IN POSITION, LOWER AIRCRAFT (NOTE- AIRCRAFT CAN ALSO BE PUSHED ON THE SKIS BY REMOVING TAIL WHEEL AND SPRINGS, IF INSTALLED).
7. INSTALL SKIS PER INSTALLATION NOTES.
8. INSTALL LEG BRACKET (8) (USING WEDGE BOLTS TO POSITION) AND WASHERS (33).
9. INSTALL (5) ON (8) WITH (17, 18).
10. INSTALL (38 L & R) PER DETAIL "A", INSTALL (3) TO (38 L & R) PER DETAIL "A". ATTACH (3) TO OUTBOARD HOLE IN SKI TIP.
11. INSTALL 47 PER DETAIL "B". INSTALL (4) ON (47) WITH (17, 18), ATTACH (4) ON INBD HOLE ON SKI TIP.
12. PLACE AIRSPEED RESTRICTION PLACARD (48) ON INSTRUMENT PANEL IMMEDIATELY ADJACENT TO AIRSPEED INDICATOR AND IN FULL VIEW OF PILOT.

DO NOT EXCEED 160 KTIAS WITH AIRGLAS LW3600-180A SKIS INSTALLED

SEE DETAIL A SHEET 2

SEE DETAIL B SHEET 2

SEE DETAIL C SHEET 2

ALTERNATE SKI AXLE POSITION

NOTE: ITEMS (3) & (4) ATTACHED TO TIP OF SKI WITH SEPERATE TABS. TWIST TABS ON BOLTS (9) INBOARD TO ALIGN WITH CABLE LOADS.

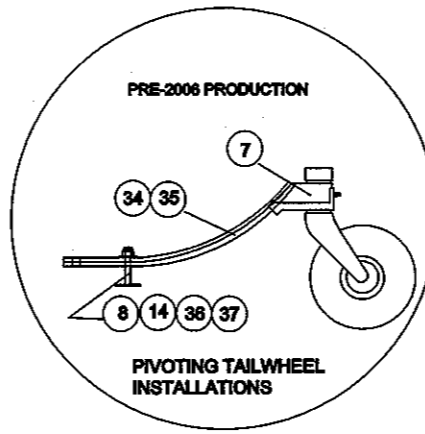
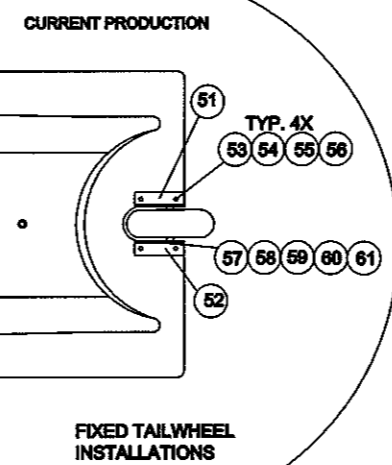

		REVISIONS				
REV	DESCRIPTION	DATE	APPRD BY			
F	COMPARED TO ONE RELOCATED DETAIL A & NO. 6 TO SHEET 2. ADDED P/N 180, WHEEL, CONTROL, WHEEL P/N NUMBER CHANGES	4/4/12	JDH			
61	2	AN380-3-2	COTTER PIN	FIXED TAIL WHEEL INSTALLATIONS		
60	2	AN310-8	NUT	FIXED TAIL WHEEL INSTALLATIONS		
59	2	AN960-816	WASHER	FIXED TAIL WHEEL INSTALLATIONS		
58	4	NAS75-8-012	BUSHING	FIXED TAIL WHEEL INSTALLATIONS		
57	2	AN8-32	BOLT	FIXED TAIL WHEEL INSTALLATIONS		
56	8	AN4-6A	BOLT	FIXED TAIL WHEEL INSTALLATIONS		
55	8	2931	SS LARGE AREA WASHER (OR EQUIVLANT BOLTDEPOT.COM)	FIXED TAIL WHEEL INSTALLATIONS		
54	8	AN960-4	WASHER	FIXED TAIL WHEEL INSTALLATIONS		
53	8	MS21044N4	NUT	FIXED TAIL WHEEL INSTALLATIONS		
52	2	L20500-18-1	BRACKET	FIXED TAIL WHEEL INSTALLATIONS		
51	2	L20500-18-2	BRACKET	FIXED TAIL WHEEL INSTALLATIONS		
50	2	PA32-206L-5	BUSHING	FIXED TAIL WHEEL INSTALLATIONS		
49	2	TWNP-66	6" TAIL WHEEL	FIXED TAIL WHEEL INSTALLATIONS		
48	1	LW3600-180A-11	PLACARD			
47		RESERVED				
46	A/R	AN365-1032	NUT			
45	4	MS20002C6	WASHER			
44	4	MS20002C5	WASHER			
43	A/R	AN3-5A	BOLT			
42	4	AA1005-7	OILITE BUSHING			
41	2	AN364-624	NUT			
40	2	AN6-5A	BOLT			
39	2	17564	30			
38	1	17564	LW3600-180A-9 & -10	FORWARD RIGGING BRACKET LH & RH		
37	2	AN363C-616	BOLT	6 EACH FOR PIVOTING TAIL WHEEL INSTALLATIONS		
36	A/R	AN960-10	WASHER			
35	2	30512-04	SPRING	PIVOTING TAIL WHEEL INSTALLATIONS		
34	2	30512-02	SPRING	PIVOTING TAIL WHEEL INSTALLATIONS		
33	4	17564	7676			
32	2		8.50X6 6 PLY	GOODYEAR, GOODRICH, MCCREARY		
31	2		1441003-1	AXLE		
30	4		NAS145-46	BOLT		
29	6		AN5-36A	BOLT		
28	2	17564	LW3600-180-8	BRAKE SPACER		
27	4		NAS146-47	BOLT		
26	4		MS9047-162	ROLL PIN		
25	4	17564	NS-10-32-3	NYLON SCREW		
24	A/R		AN960-1216	WASHER		
23	4		NAS1312-15	BOLT		
22	2	17564	LW3600-180A-7	INBOARD FITTING		
21	2	17564	LW3600-180A-6	OUTBOARD FITTING		
20	2	17564	LW3600-180-5	STUB AXLE		
19	2	17564	LW3600-180-4A	FLANGE		
18	4		AN380-3-2	COTTER PIN		
17	4		AN395-17	CLEVIS PIN		
16	6		AN6-5	BOLT		
15	16		AN5-7A	BOLT		
14	16		AN960-616	WASHER		
13	10		AN363-624	NUT		
12	2	17564	EB-616-21	BOLT		
11	24		AN960-516	WASHER		
10	10		AN363-524	NUT		
9	4		AN5-6A	BOLT		
8	2	17564	L44000-11-10	TAB		
7	2	17564	D501A	TAIL WHEEL ASSY		
6	2	17564	LW3600-180A-27	LEG BRACKET		
5	2	17564	LW3600-180A-3	CHECK CABLE ASSY.		
4	2	17564	LW3600-180A-2	SAFETY CABLE ASSY.		
3	2	17564	LW3600-180A-1	BUNGEE ASSY.		
2	1	17564	LW3600-2	RIGHT SKI		
1	1	17564	LW3600-1	LEFT SKI		
X		17564	LW3600-180A	SKI KIT		
NO.	QTY	CODE	IDENT-NO	PART NO.	DESCRIPTION	NOTES

LIST OF MATERIALS		CONTRACT NO.		SPECIAL CONTROL NO.	
UNLESS OTHERWISE SPECIFIED DIMENSIONS ARE IN INCHES	ANGLAS			Airglas, Inc. Andover, Maine	
DECIMALS 1/16" 3/32" 1/8" 5/16" 3/8" 1/2" 5/8" 3/4" 7/8" 1"	FRAC			LW3600 SKI INSTALLATION WITH 2 POSITION FITTINGS ON CESSNA 180,185	
MATERIAL	QTY	APPROVED BY: JDH	DATE: 04 APR 2012	REV	
STEEL	1	CHECKED BY: JDH		B	17564
ALUM.	1	DRAWN BY: CDB			LW3600-180A
MARK. CAST	1				F
APPLICATION					

THIS DRAWING INCLUDES INFORMATION PROPRIETARY TO AIRGLAS, INC. AND IS SUBMITTED FOR EVALUATION ONLY AND SHALL NOT BE USED TO MANUFACTURE OR REPRODUCE WITHOUT PERMISSION OF AIRGLAS, INC.

REVISIONS			
REV	DESCRIPTION	DATE	APPRD BY
A	CONVERTED TO CAD, MOVED DETAIL B, LATE MODEL DETAIL A, AND DETAIL C TO SHEET 2 OF 2	4/4/12	JDH
B	ITEM 20 CALL OUT ADDED, DRILL NOTES TIED TO LOCATION OF HOLES.	4/28/12	JDH

NOTE: MOUNT BRACKET (38) SO AFT EDGE IS PARALLEL TO STA. 0.00

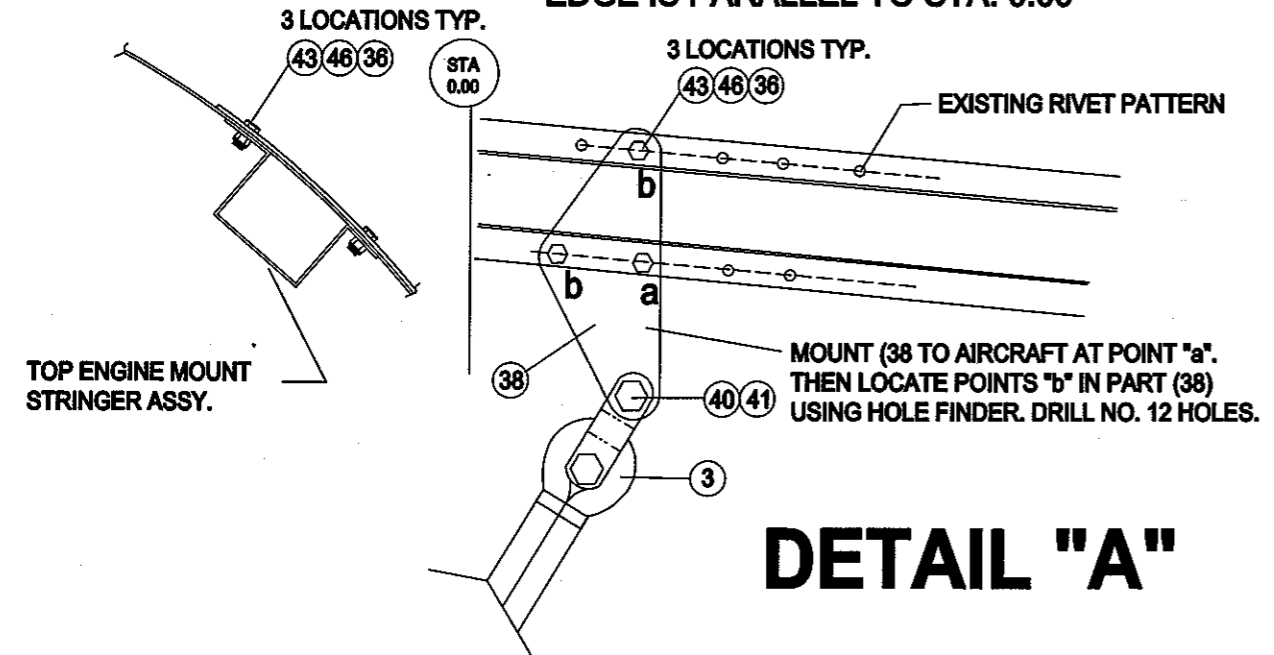

DETAIL "A"

CESSNA 180G THRU 180K AND 185 AIRCRAFT

NOTE: MOUNT BRACKET (38) SO AFT EDGE IS PARALLEL TO STA. 0.00

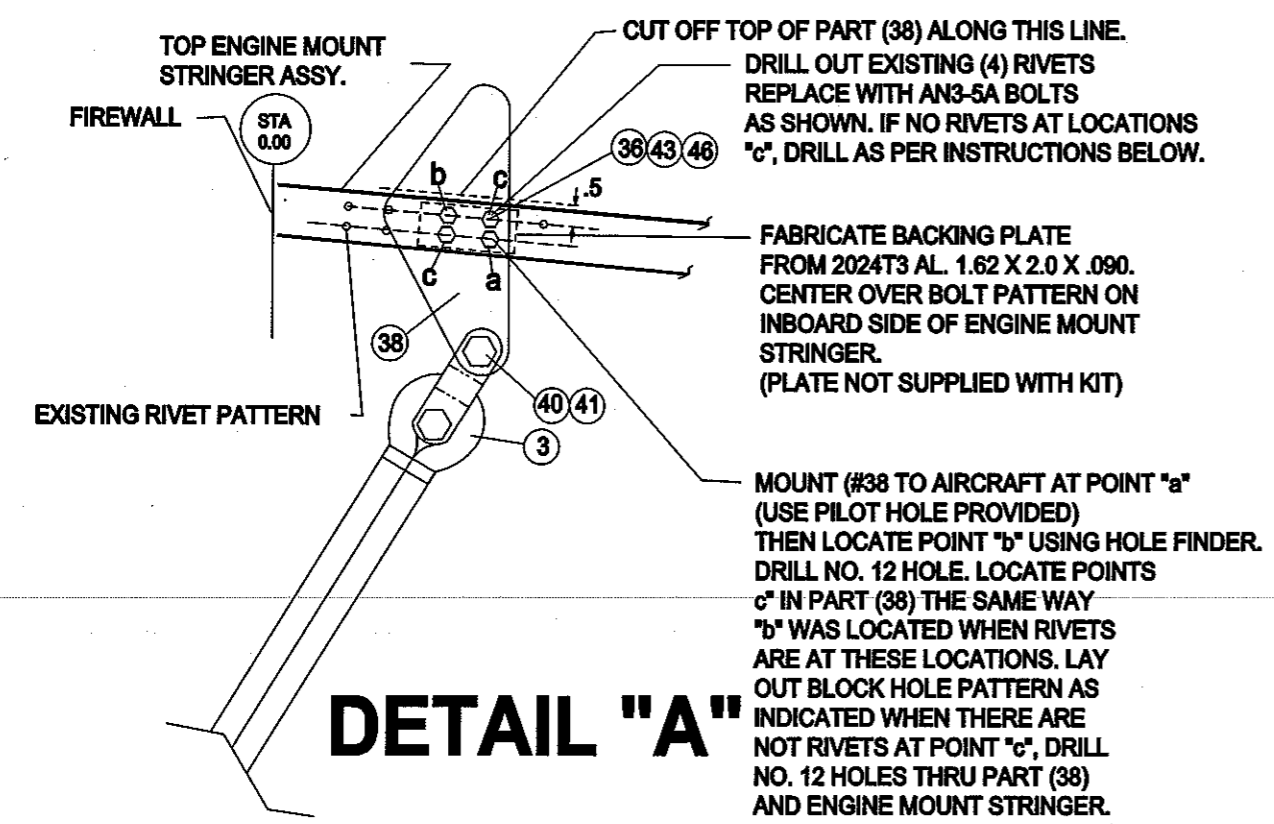

DETAIL "A"

CESSNA 180 THRU 180F AIRCRAFT

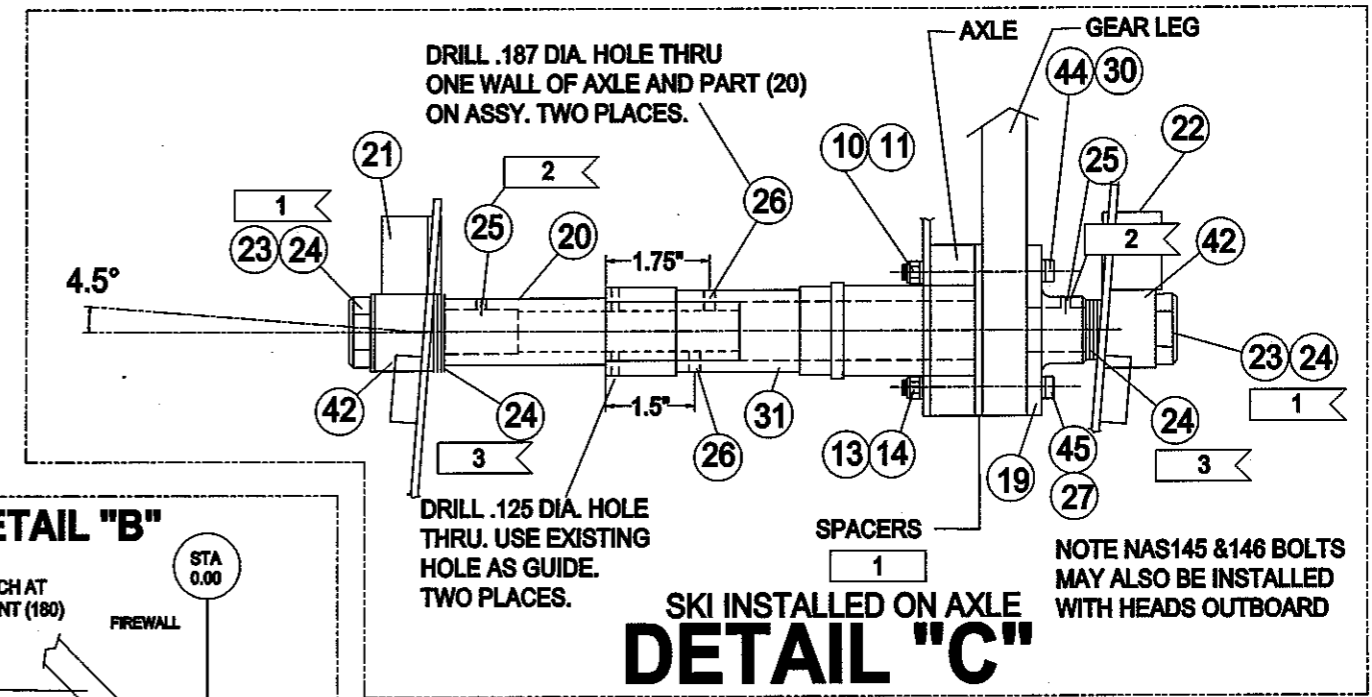

SKI INSTALLED ON AXLE DETAIL "C"

SERVICE NOTES

- 1 CHECK WHEEL ALIGNMENT PER CESSNA INSTRUCTIONS FOR BEST SKI OPERATION, FAVOR LOWER LIMIT FOR TOE IN AND CAMBER.
- 2 REMOVE BUNGEE BEFORE CHANGING SKI POSITION.
- 3 AIRCRAFT WEIGHT MUST BE ON TIRE TO CHANGE POSITIONS.
- 4 WHEEL BEARINGS SHOULD BE PACKED WITH LOW TEMP GREASE.

INSTALLATION NOTES

- 1 TIGHTEN NAS1312-15 BOLT UNTIL IT JUST MAKES CONTACT WITH OILITE BEARING THEN TIGHTEN 1/8 TURN. (WARNING DO NOT TIGHTEN BEYOND, OR OILITE BEARING WILL BE CRUSHED.)
- 2 INSTALL NYLON LOCK SCREW NS-10-32-3 UNTIL VISIBLE IN BORE. NAS1312-15 BOLT WILL BE SAFELY HELD WHEN THREADED OVER LOCK SCREW.
- 3 AXLE END PLAY IS CONTROLLED BY PLACING THE PROPER NUMBER OF WASHERS BETWEEN THE INBD. FITTING AND FLANGE, AND BETWEEN OUTBD FITTING AND STUB AXLE.
- 4 MAINTAIN BRAKE CASTING TO WHEEL WELL CLEARANCE WHEN SKI IS IN FLIGHT ATTITUDE.

THIS DRAWING INCLUDES INFORMATION PROPRIETARY TO AIRGLAS, INC. AND IS SUBMITTED FOR EVALUATION ONLY AND SHALL NOT BE USED TO MANUFACTURE OR REPRODUCE WITHOUT PERMISSION OF AIRGLAS, INC.

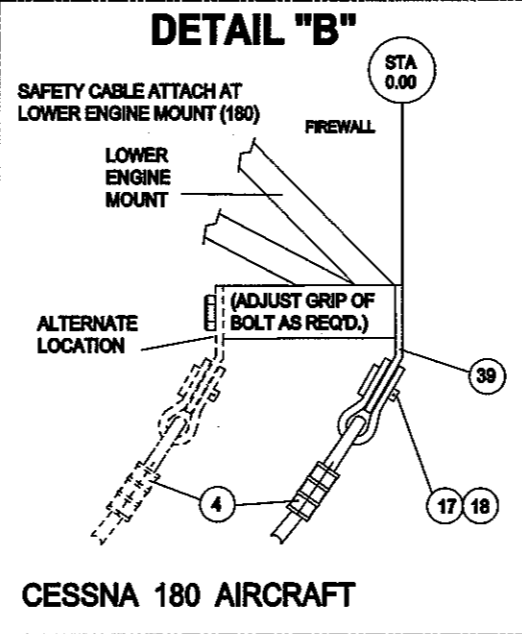

DETAIL "B"

CESSNA 180 AIRCRAFT

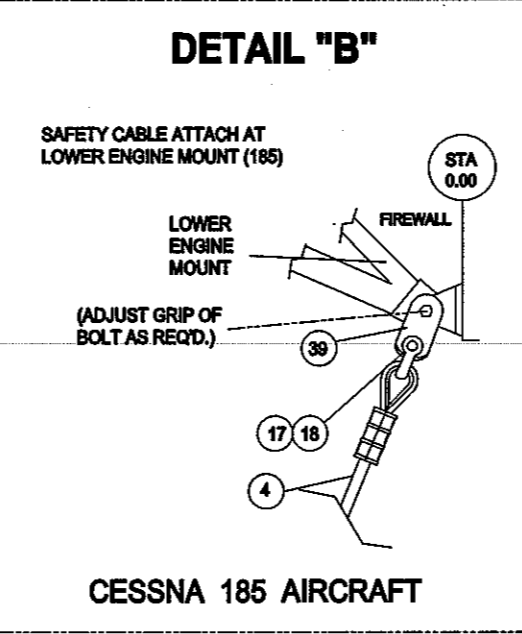

DETAIL "B"

CESSNA 185 AIRCRAFT

UNLESS OTHERWISE SPECIFIED DIMENSIONS ARE IN INCHES		CONTRACT NO.		Airglas, Inc. Annapolis, Alaska	
MATERIAL	HEAT TREAT	QTY.	SPECS.	APPROVED BY:	REV.
LW3800	STEEL	1	AS BUILT	JDH	B
ALUM.	ALUM.	1	AS BUILT	JDH	B
ALUM. CAST	ALUM. CAST	1	AS BUILT	COB	B
APPLICATION		Date: 04 APR 2012		Sheet 2 OF 2	